



**SOLVR™**

# **USER MANUAL**

# **MENU**

## Table of Contents

Menu.....	3
Category.....	3
Item.....	4
Item Code.....	5
Stock Quantity.....	7
Import item.....	8
Open Price Item.....	11
Arrangement for category.....	14
Arrangement for item.....	14
Copy Menu.....	15

# Menu

## Category

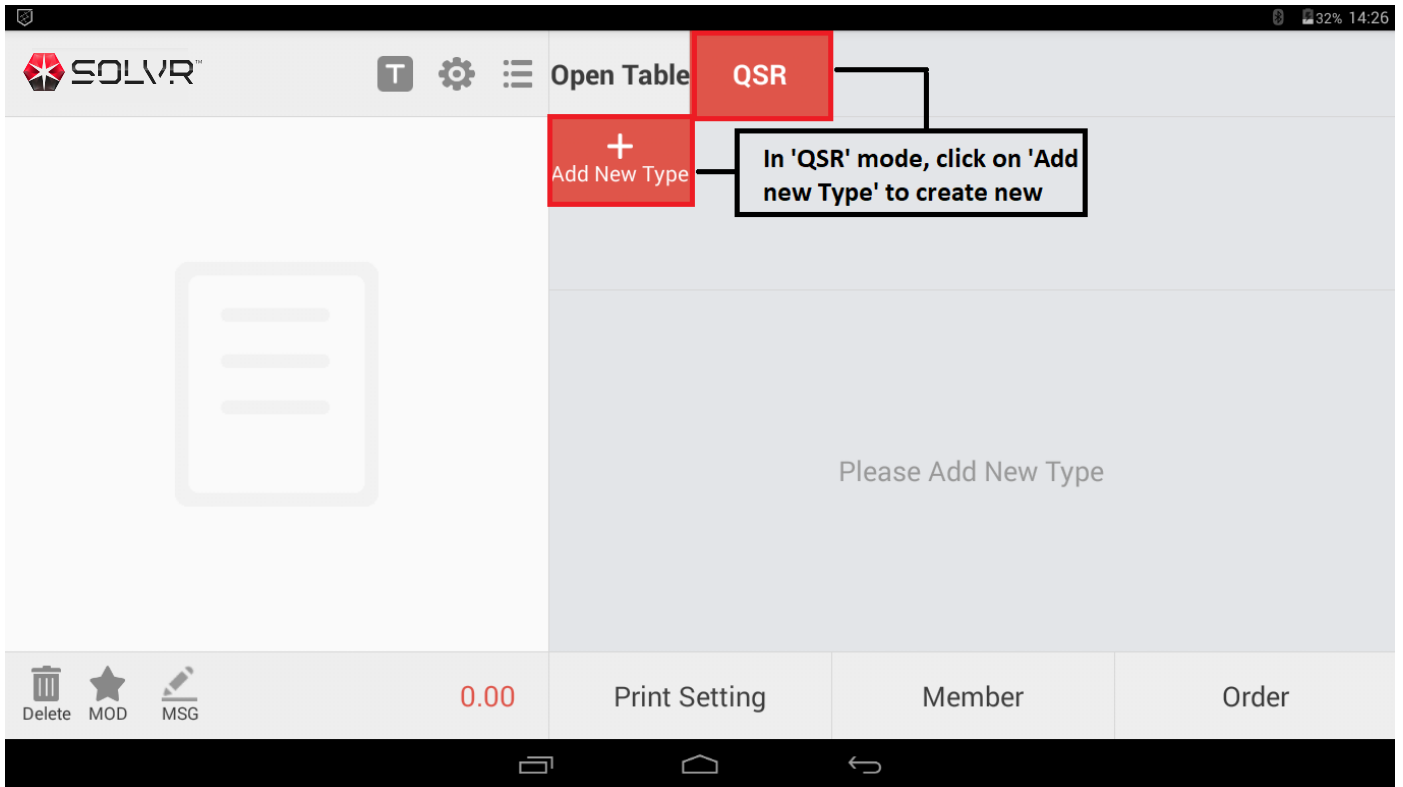

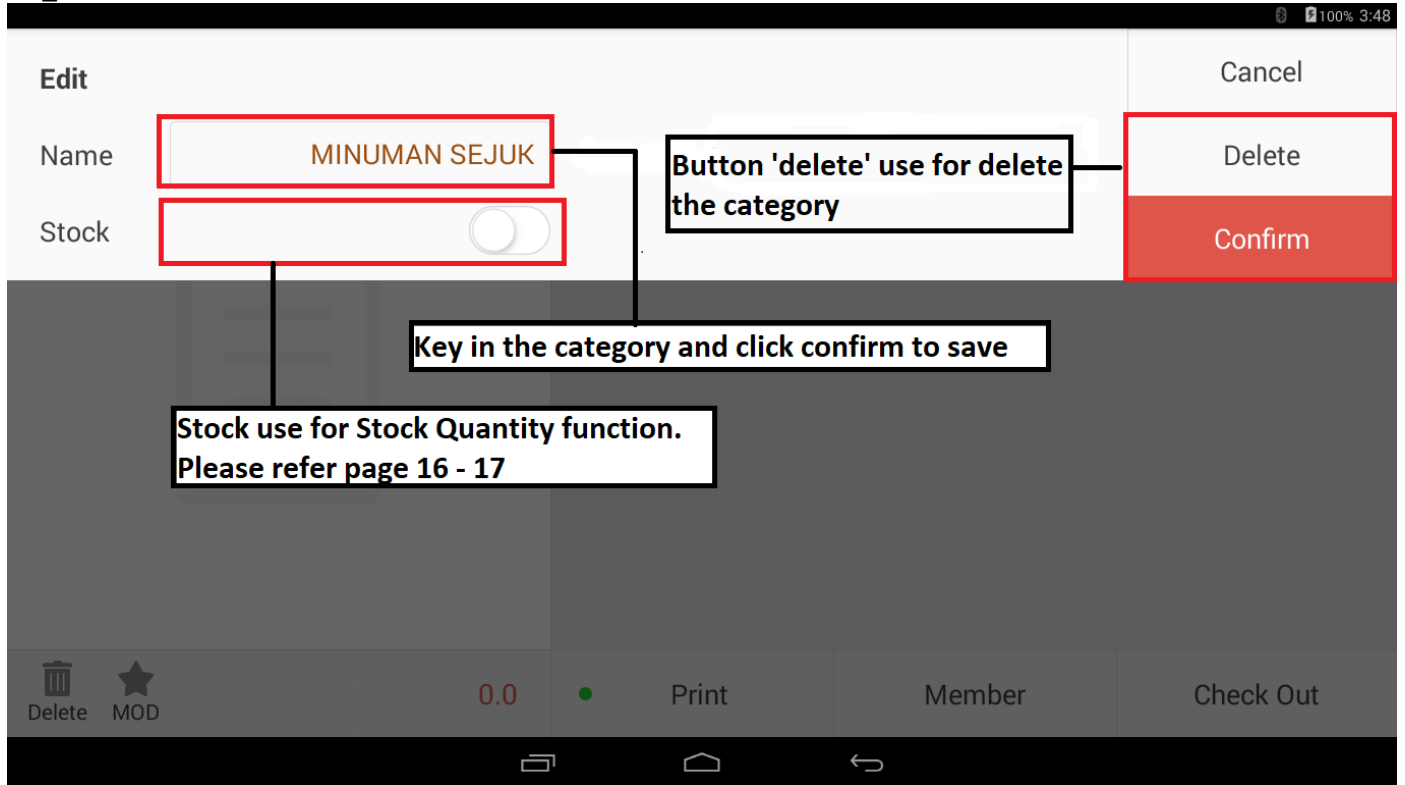

### Item

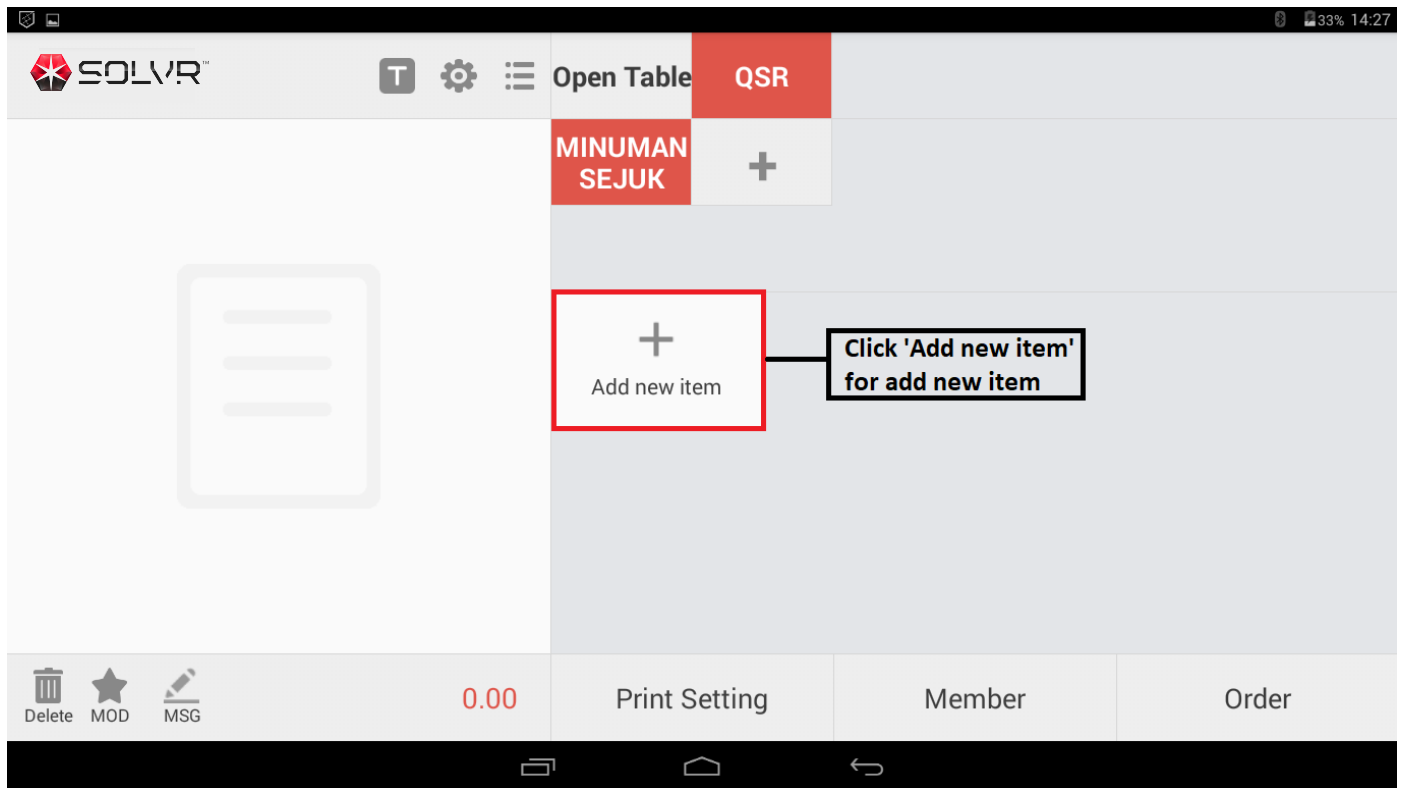

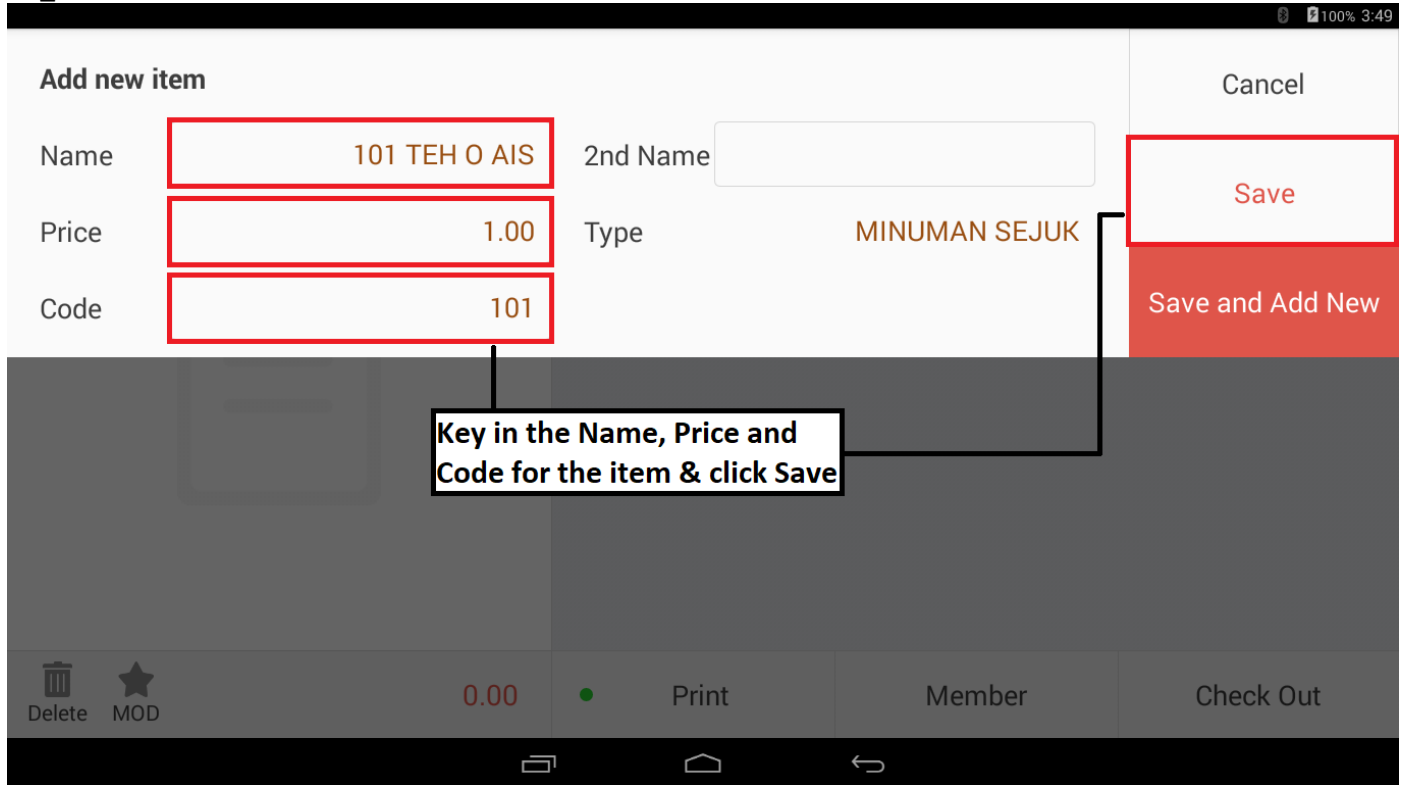

### Item Code

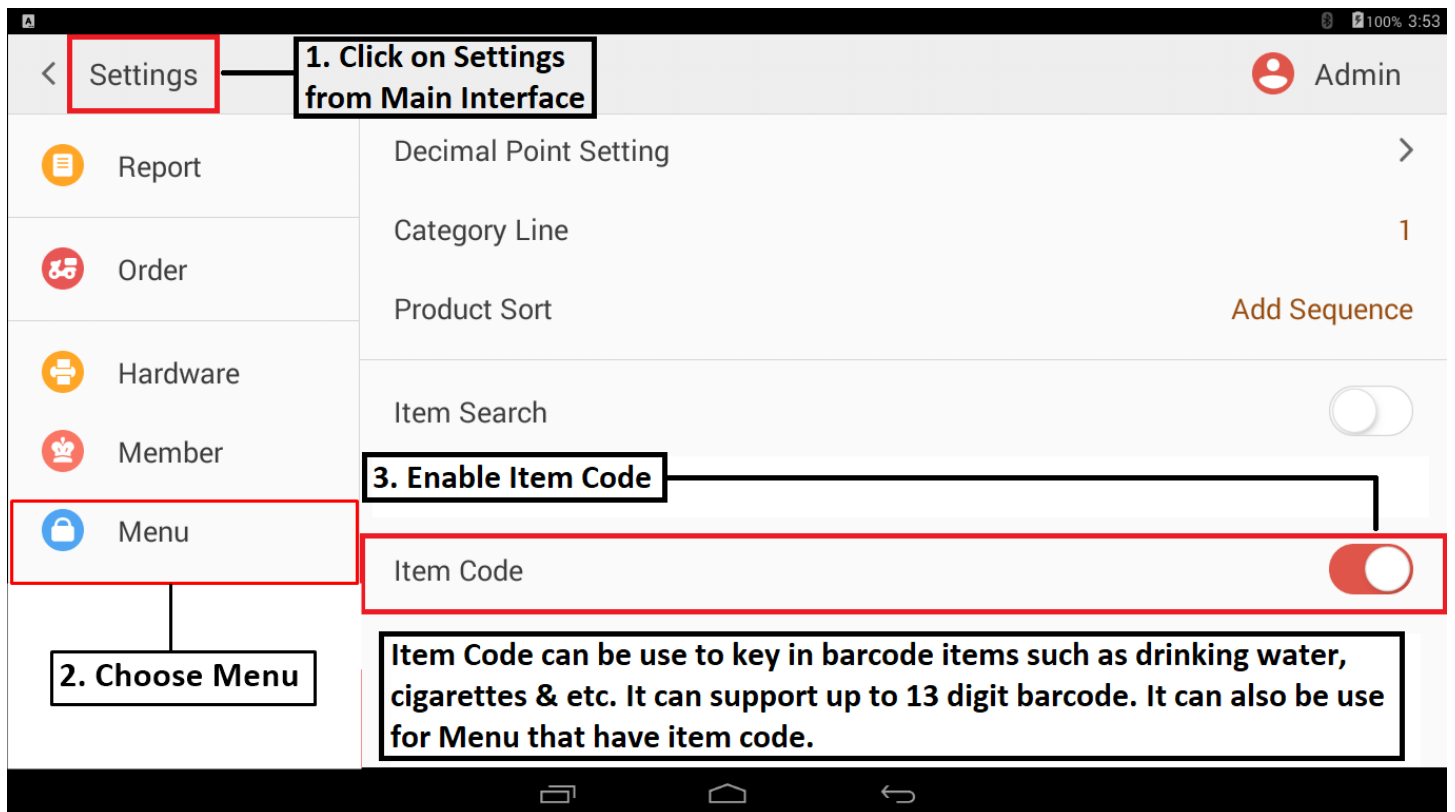



The screenshot shows the 'Edit' screen for an item named 'COFFEE-IN-A-BOX'. The 'Stock' toggle switch is highlighted with a red box. A callout box points to the toggle with the text: 'To use Stock Quantity function, when key in Category need to enable 'Stock''. The bottom navigation bar includes 'Delete', 'MOD', '0.00', 'Print', 'Member', and 'Check Out'.

The screenshot shows the 'Add new item' screen for 'NESPRESSO LEGGERO'. The 'Quantity' field is highlighted with a red box and contains the value '15'. A callout box points to the field with the text: 'There will be a column to key in Quantity in Item Maintenance after enabling Stock Quantity'. The bottom navigation bar includes 'Delete', 'MOD', '0.00', 'Print', 'Member', and 'Check Out'.

### Import item

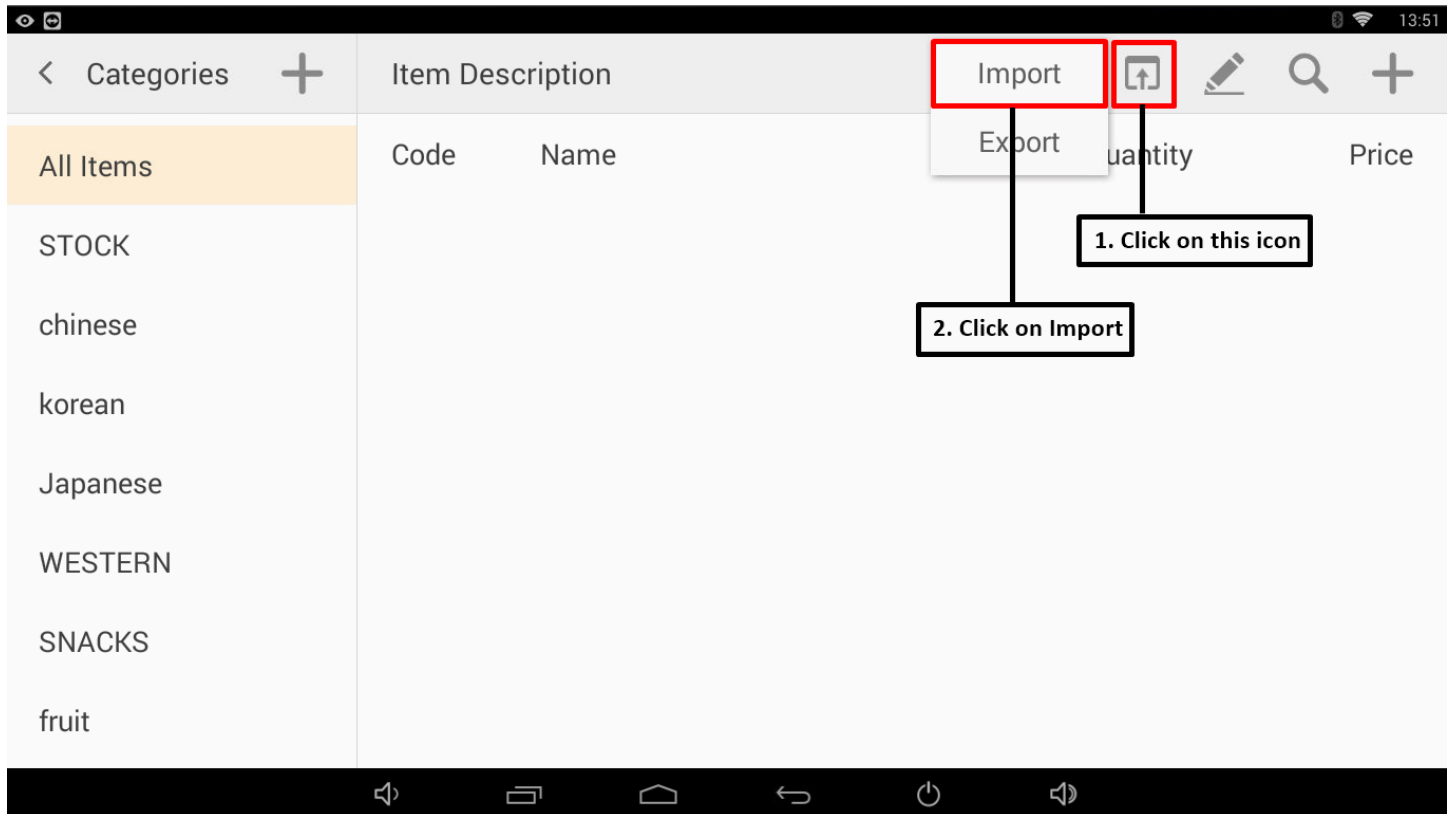
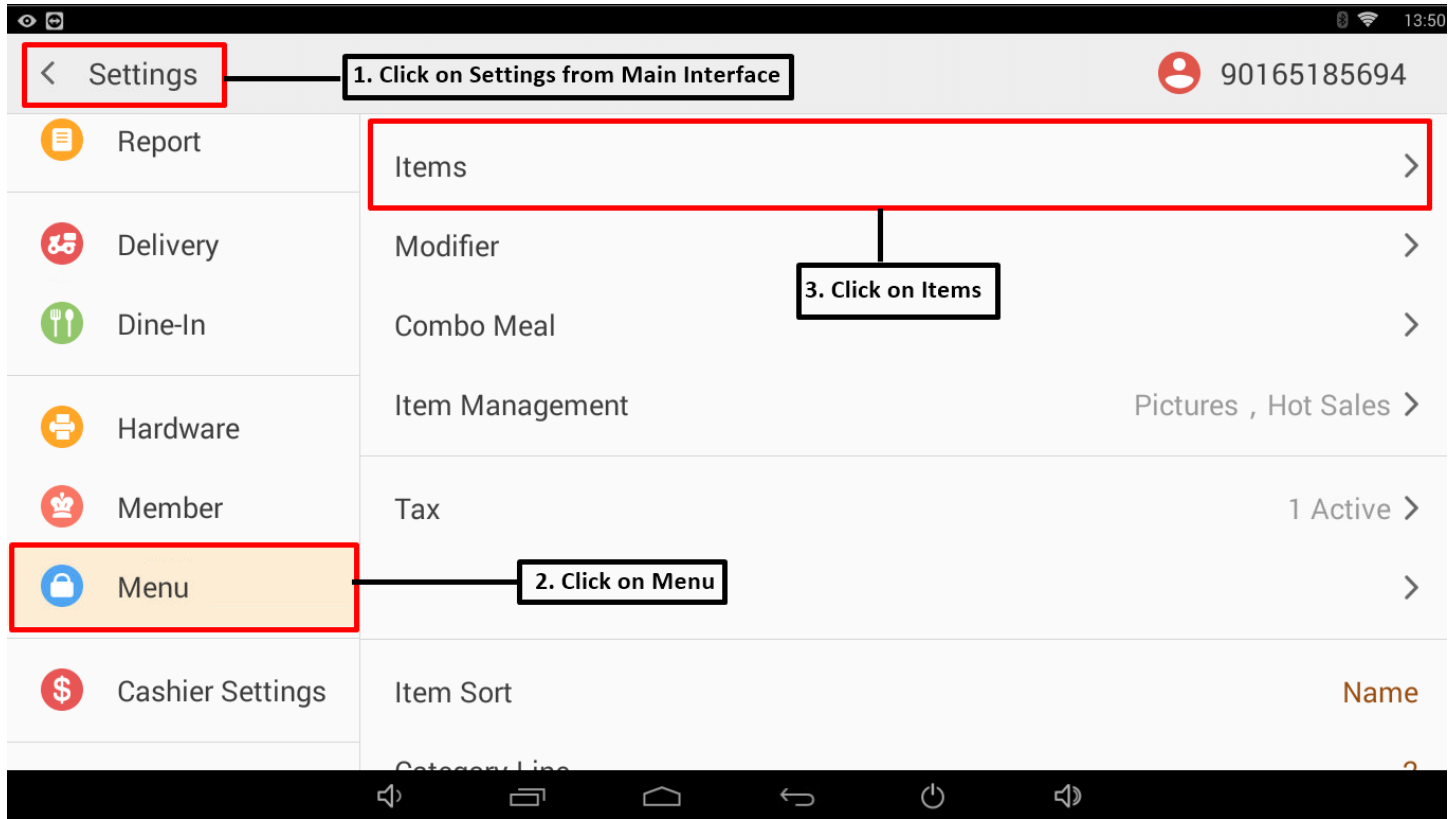



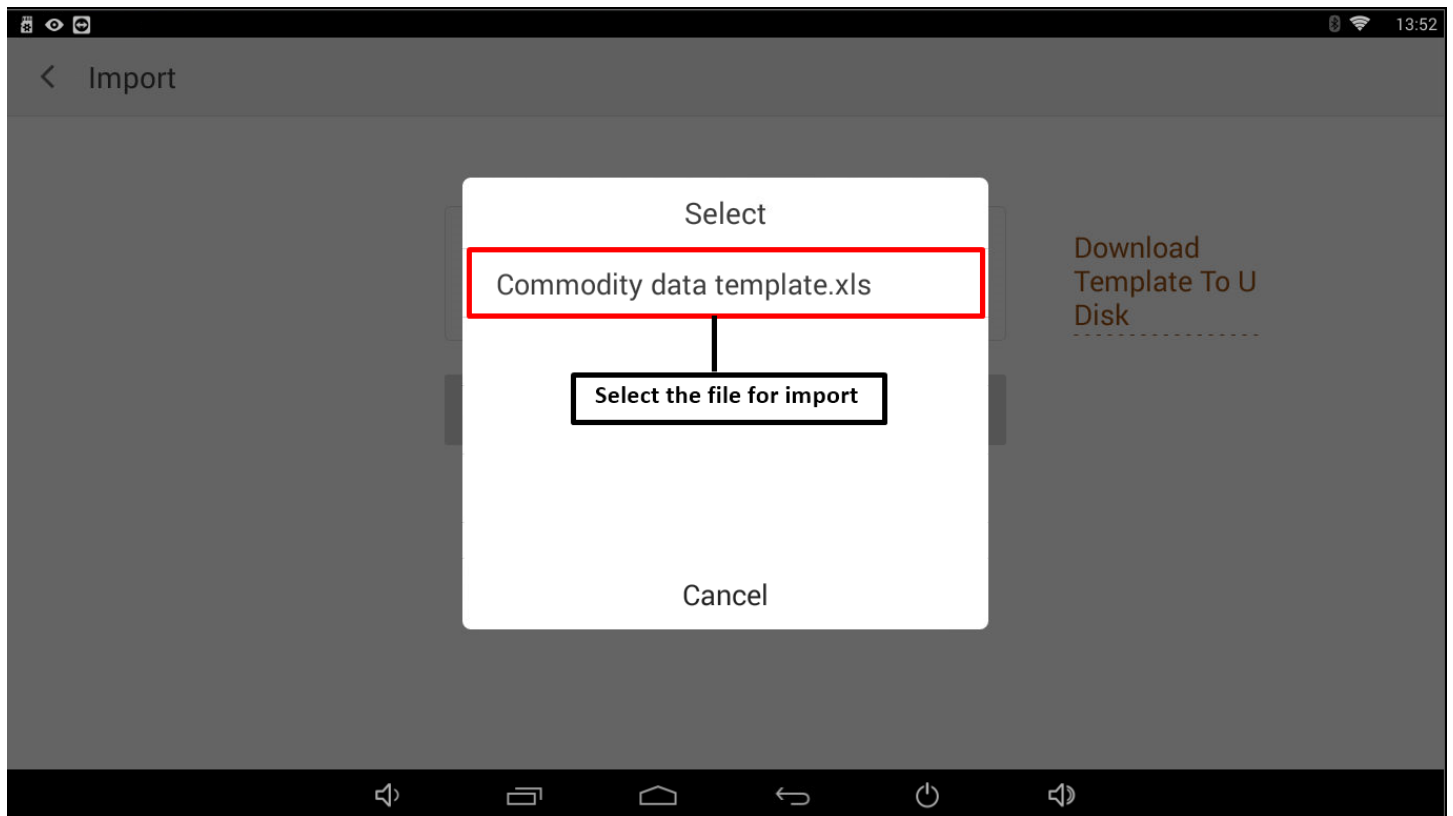
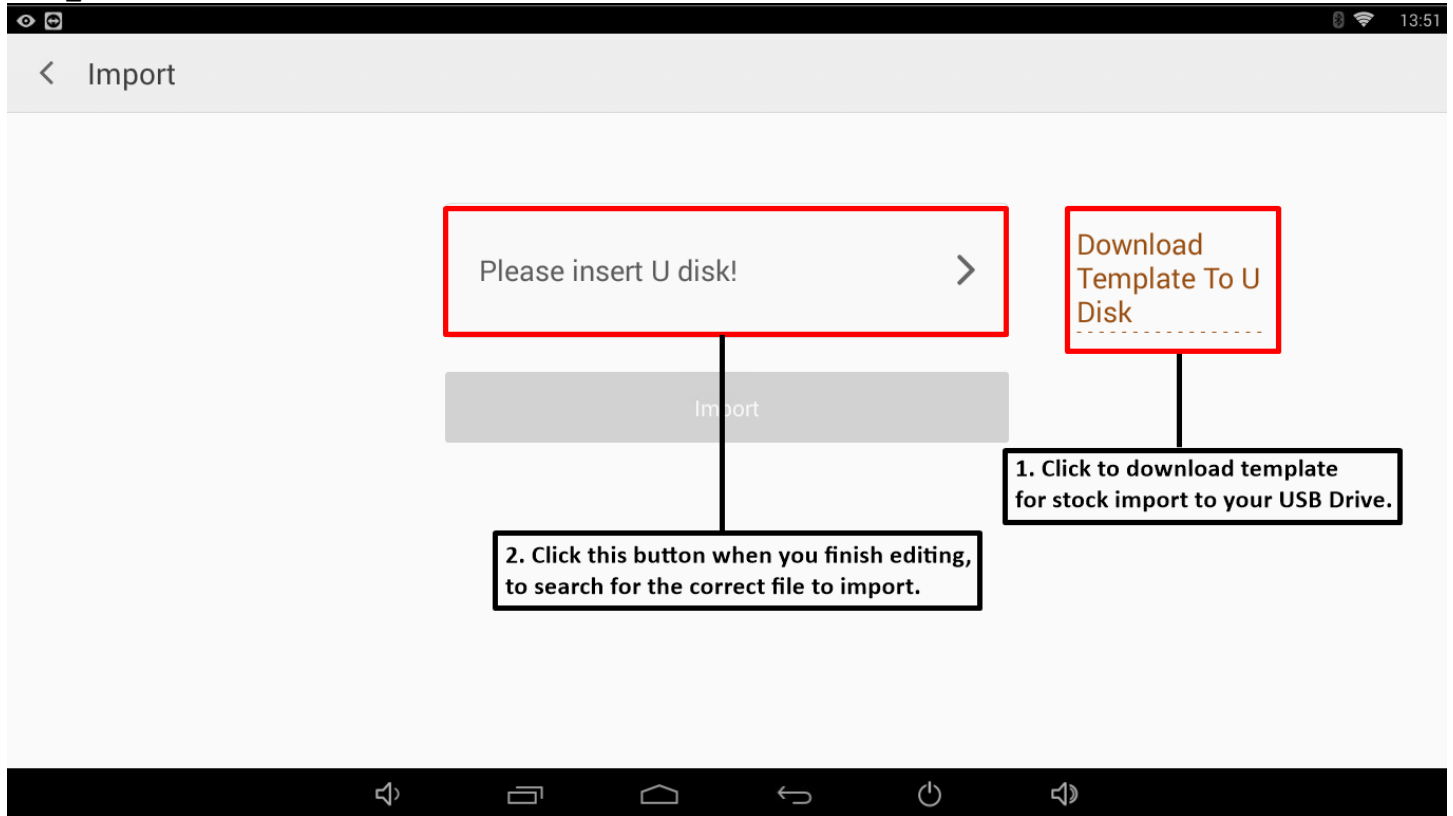

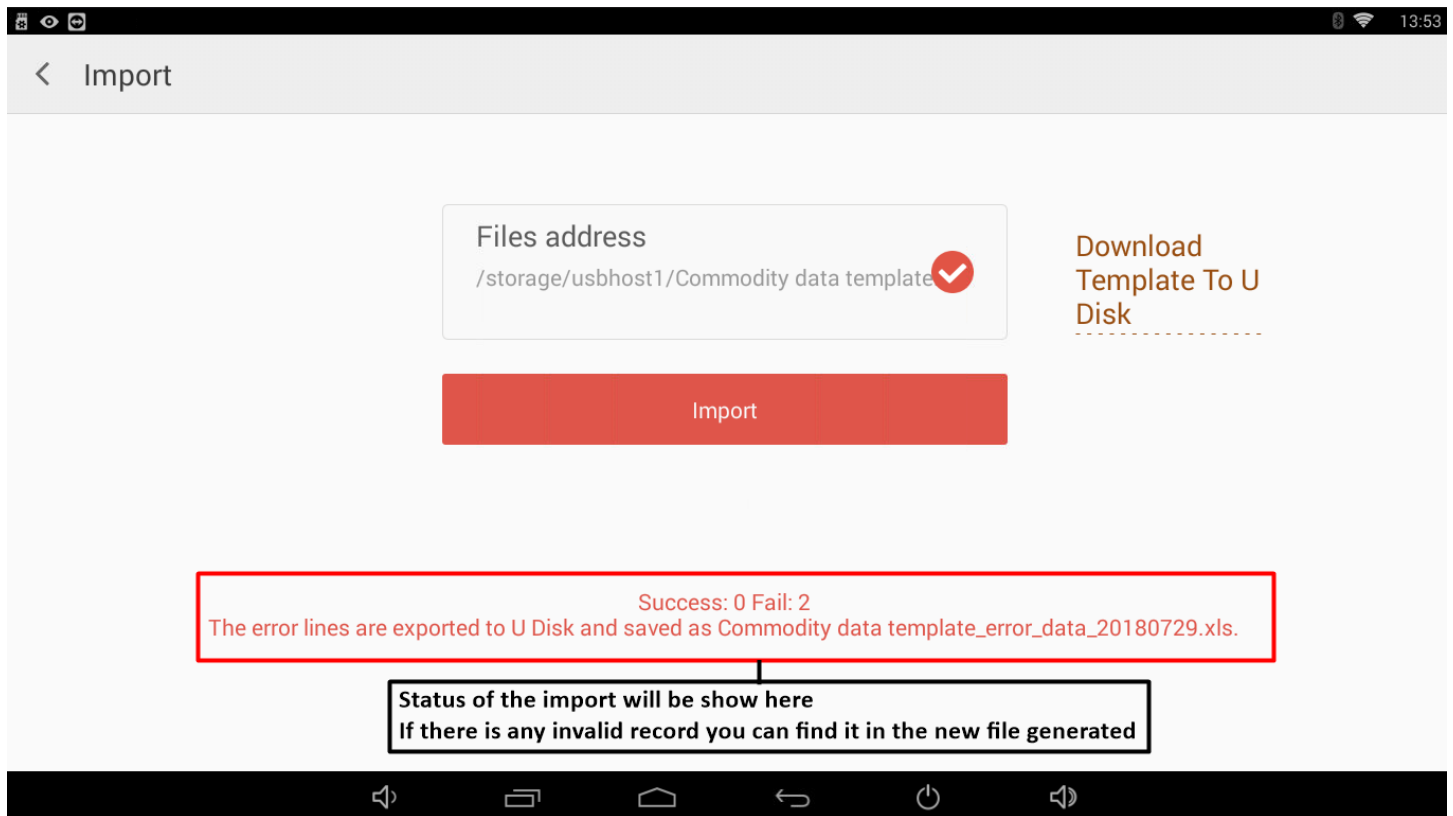
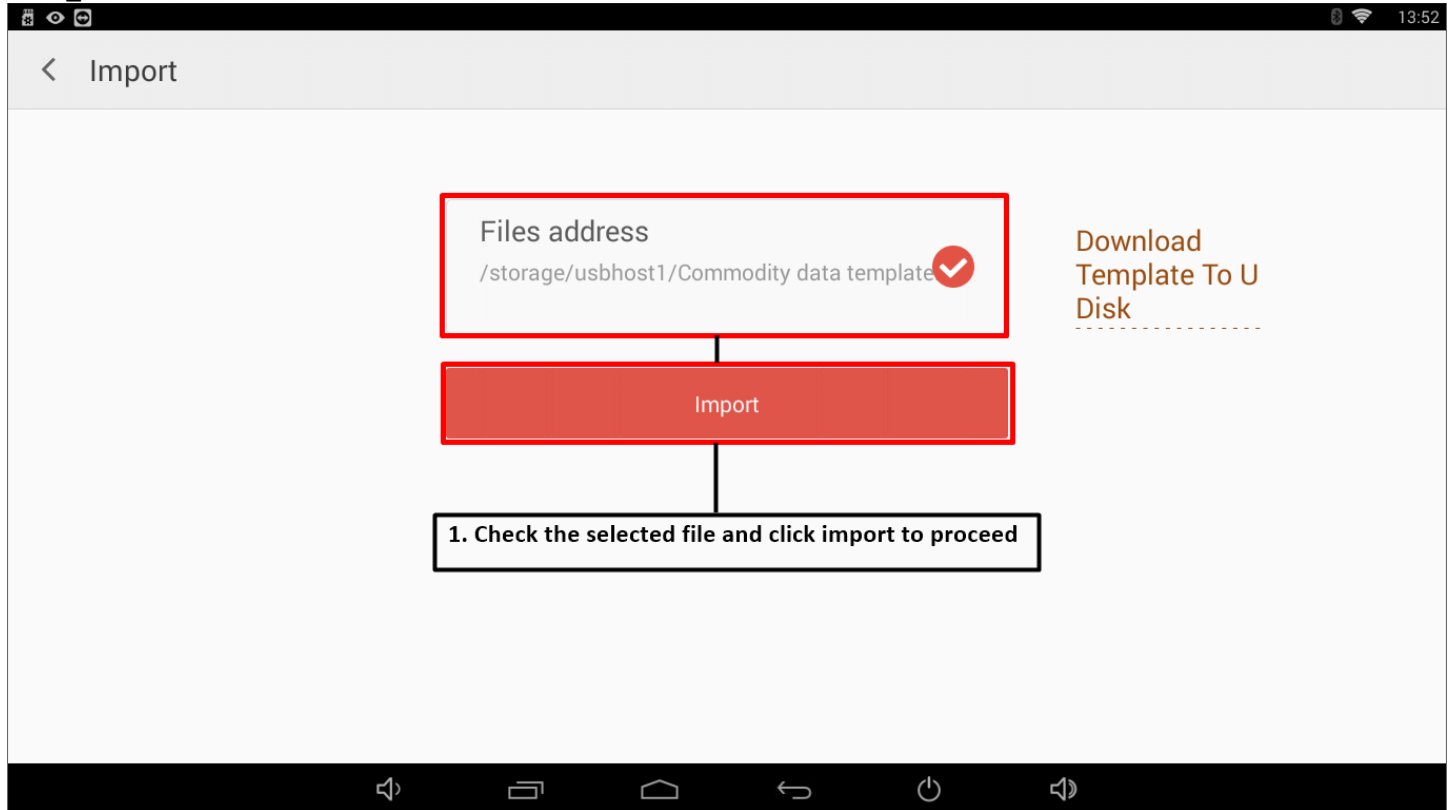

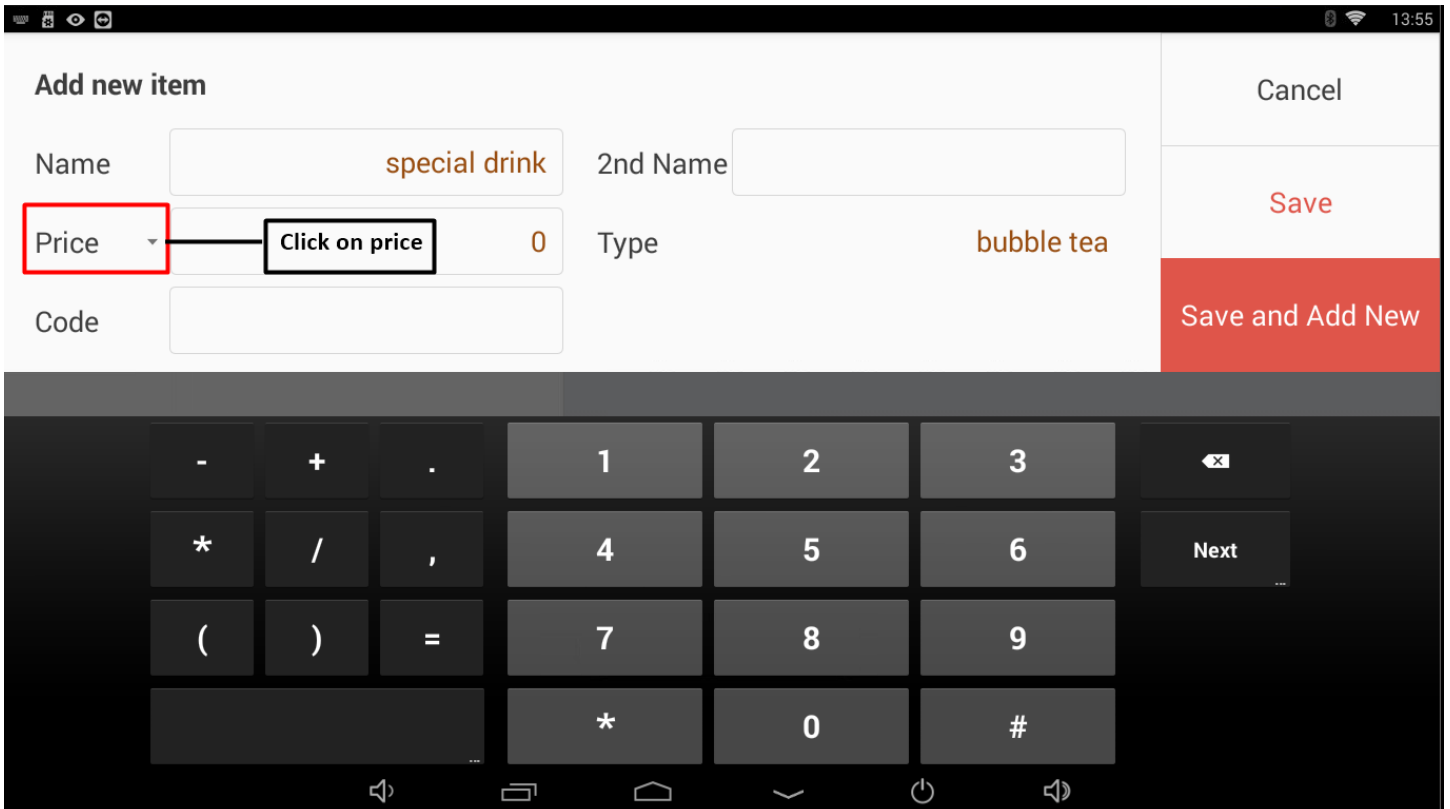
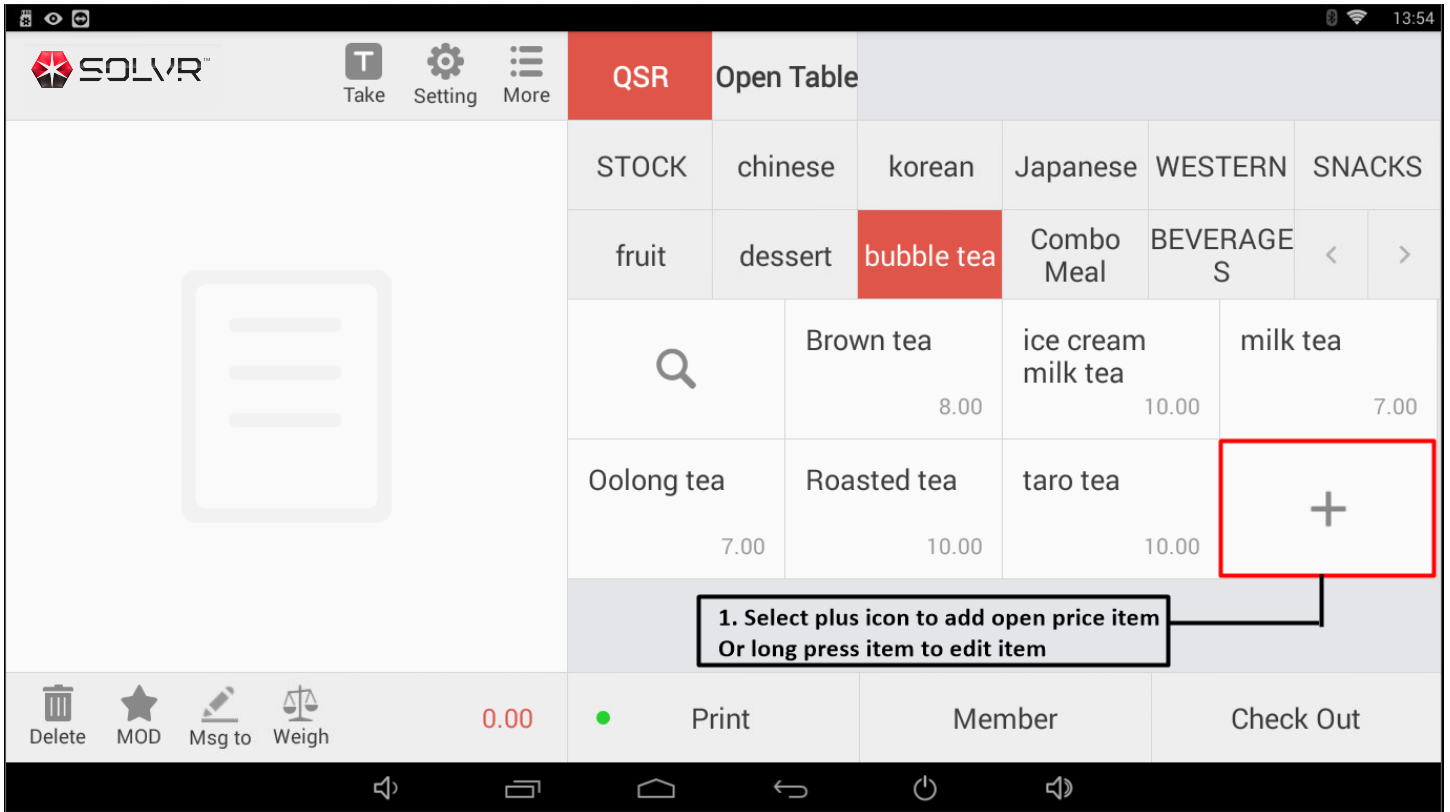

**Add new item**

Name  2nd Name

Price  Type

Price  **Select Open Price**

**Open price**

**Click save to proceed**

**Save**

**Save and Add New**

**Cancel**

Calculator interface with buttons: -, +, ., 1, 2, 3, \*, /, ,, 4, 5, 6, (, ), =, 7, 8, 9, \*, 0, #, Next, and a back arrow.

SOLVR Take Setting More

QSR Open Table

STOCK	chinese	korean	Japanese	WESTERN	SNACKS
fruit	dessert	<b>bubble tea</b>	Combo Meal	BEVERAGE S	< >
	Brown tea	ice cream milk tea	milk tea		
	8.00	10.00	7.00		
Oolong tea	Roasted tea	<b>special drink</b>	taro tea		
7.00	10.00	0.00	10.00		

**Click on Open item to order**

0.00

Print Member Check Out

Delete MOD Msg to Weigh

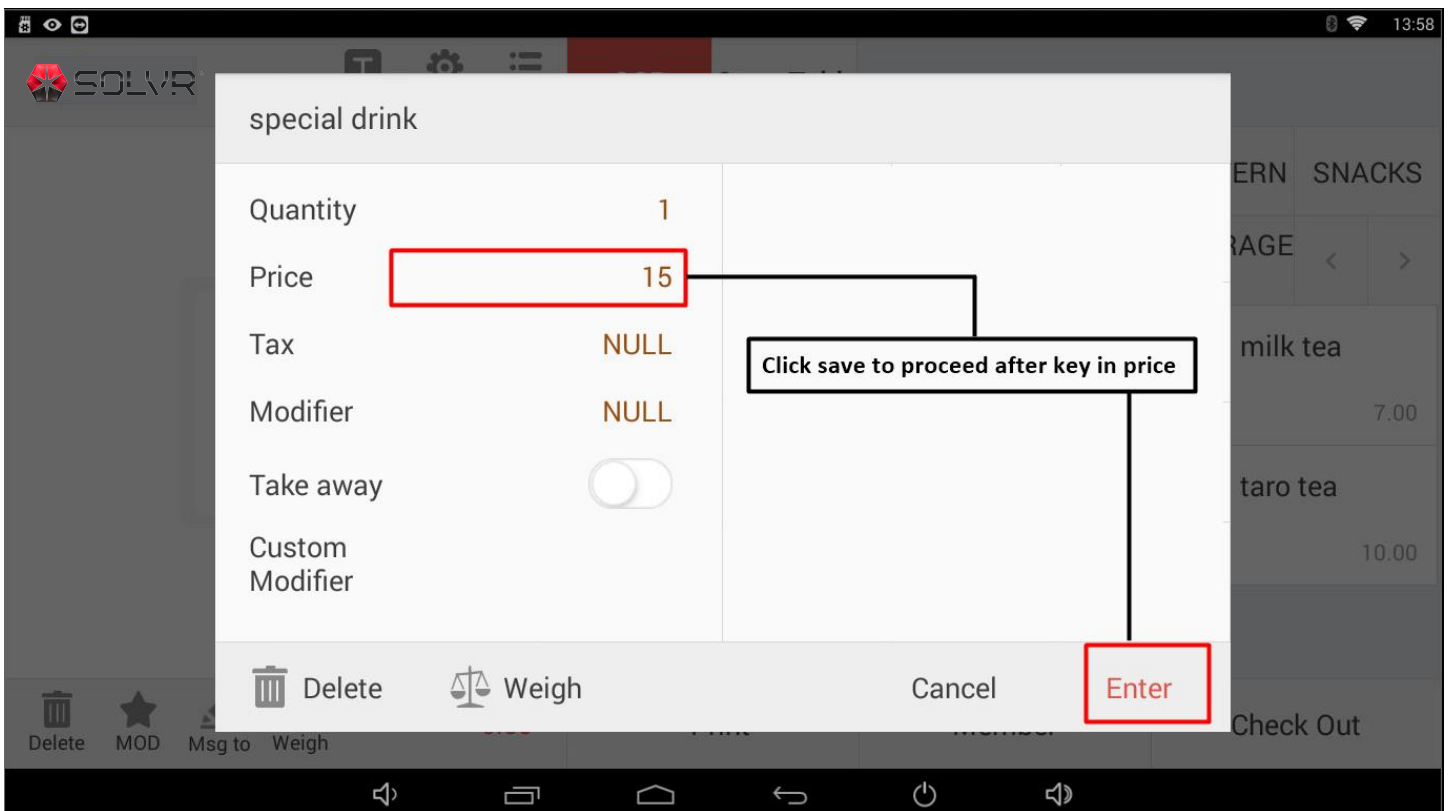
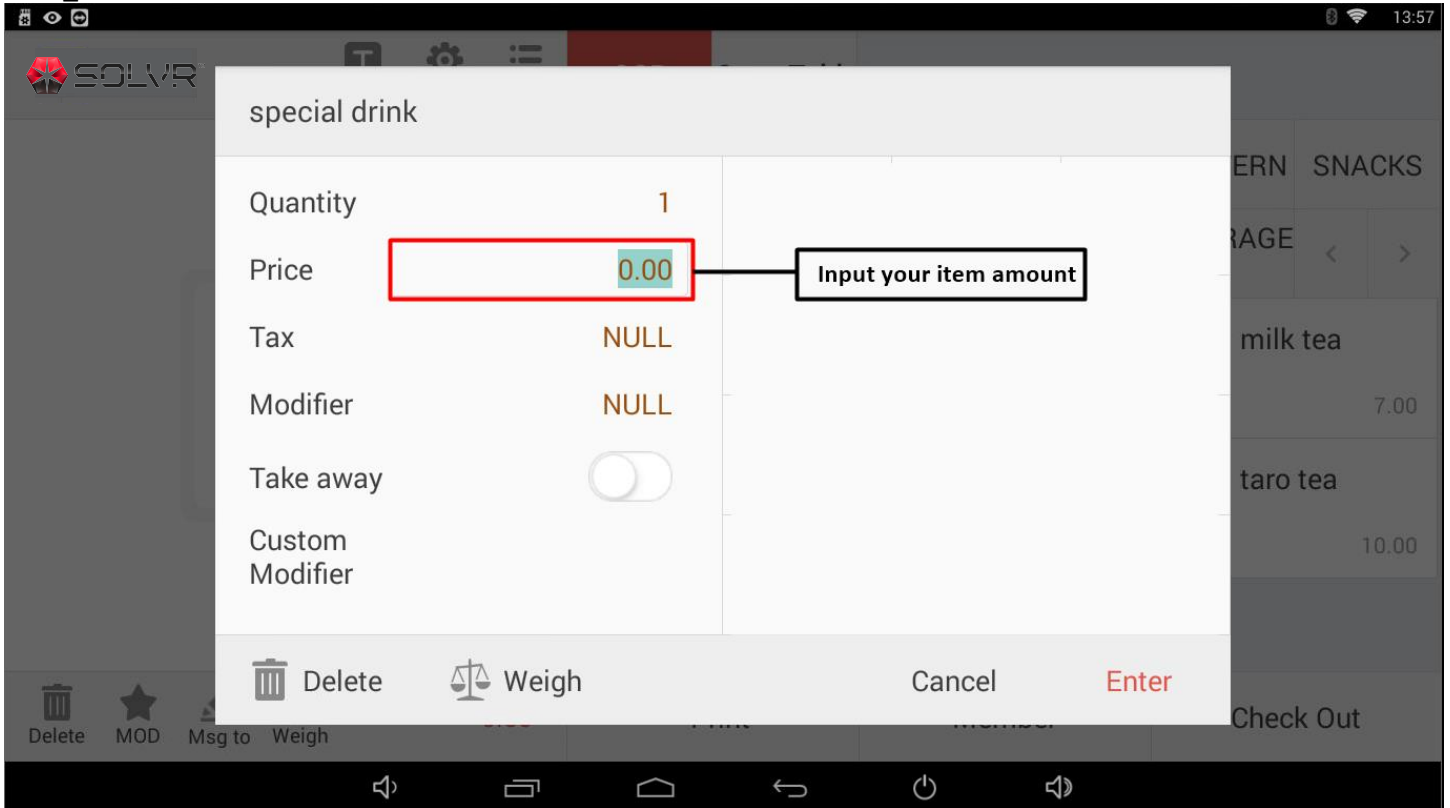

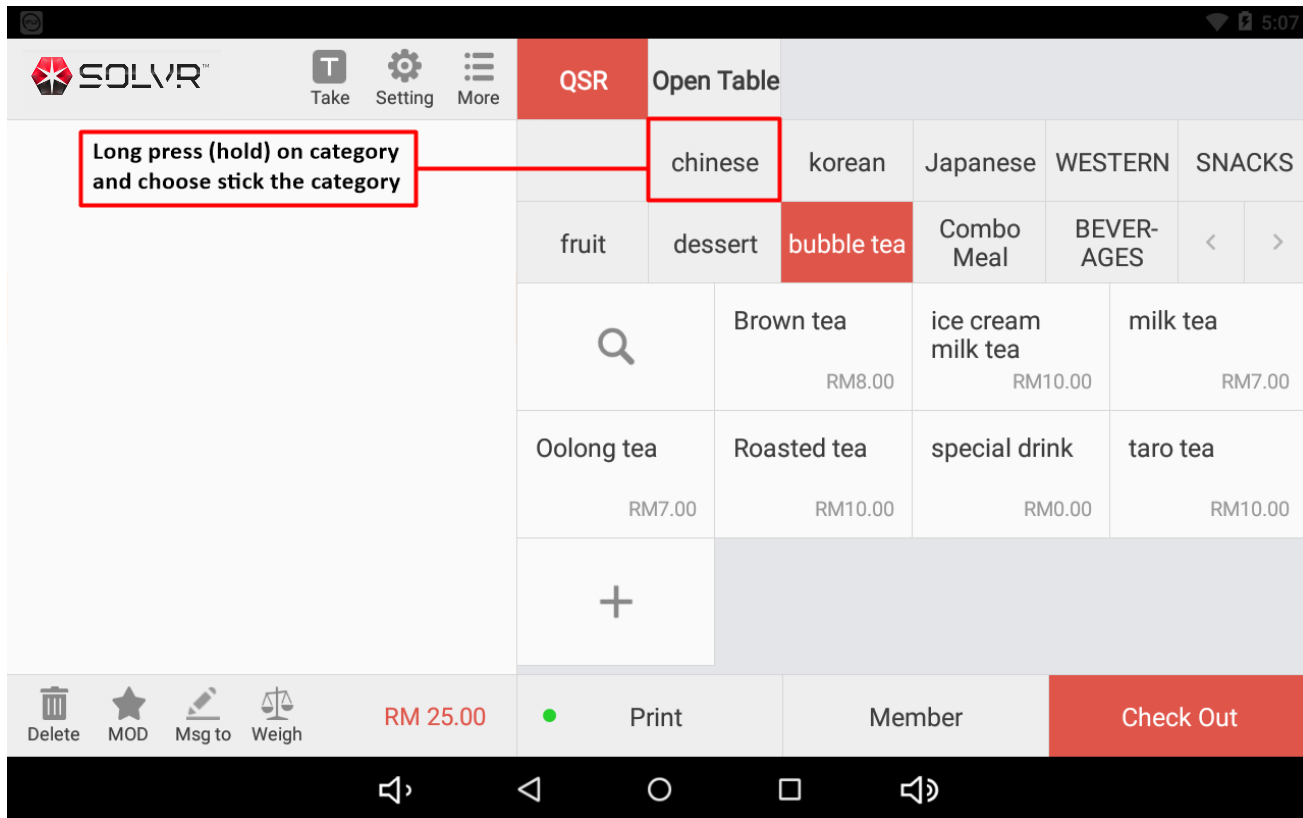

Arrangement for item

